

* Use Dragon's parts W3, W4, W5 to mount parts 13 in opened or closed position

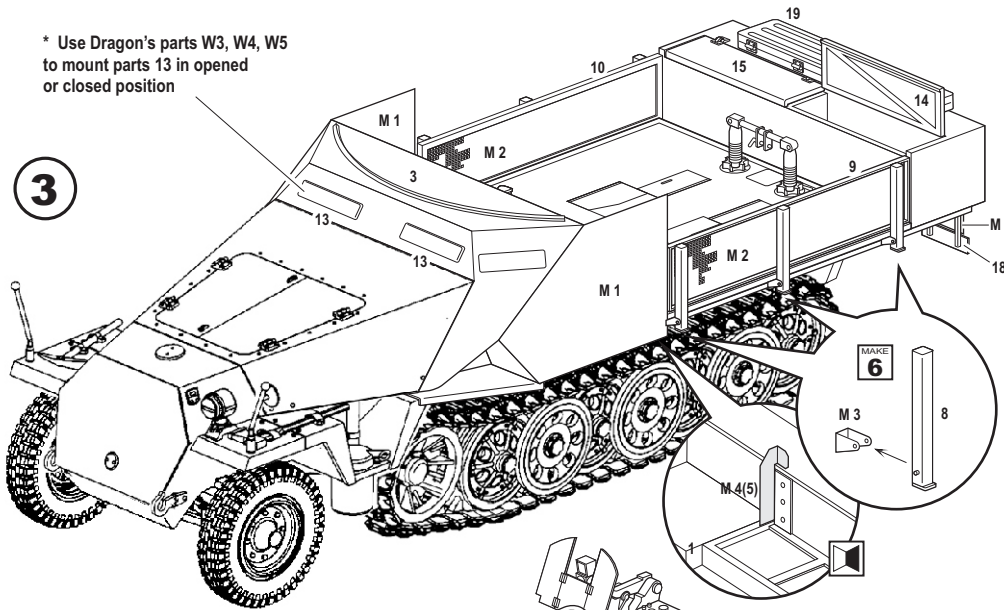

3

* Flak.38 (Tristar, Italeri or Tamiya kit)

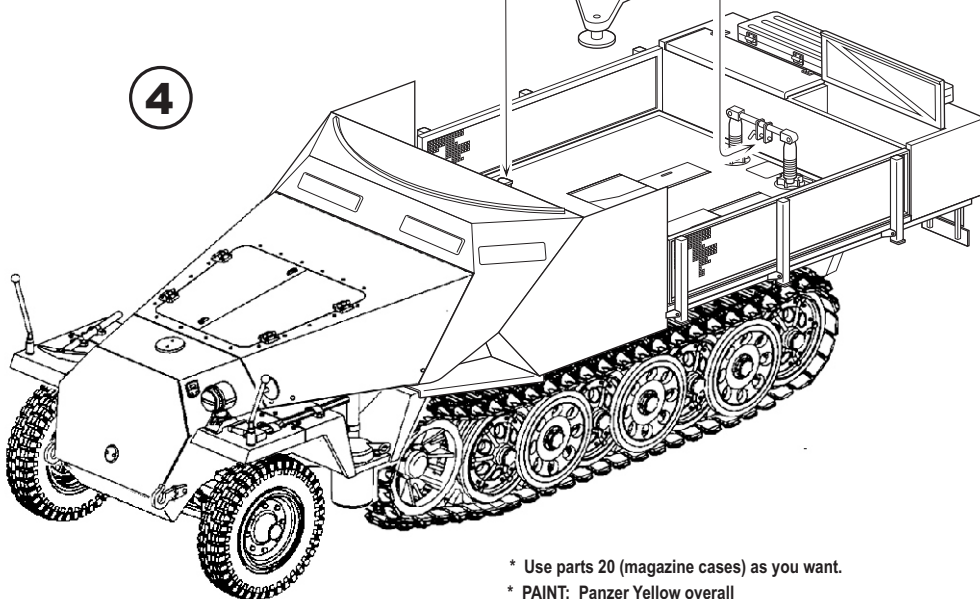

4

* Use parts 20 (magazine cases) as you want.

* PAINT: Panzer Yellow overall



LEADWARRIOR
HISTORICAL MINIATURE

WWW.LEADWARRIOR.COM
SUPPORT@LEADWARRIOR.COM
Ebay: LEADWARRIOR

2cm Flak 38 auf mittlere Schutzenpanzerwagen

Sd.Kfz. 261

(Alias Sd.Kfz.30, Sd.Kfz.11, Sd.Kfz.251/17 Neu)

31 RESIN PARTS
+ PHOTOETCH

1:35 CONVERSION KIT

for DRAGON Sd.Kfz.251/1 Ausf. D
and TAMIYA, ITALERI or TRISTAR Flak 38



The Sd.Kfz.11 (though some sources name this vehicle Sd.Kfz. 30, Sd.Kfz.261, or Sd.Kfz.251/17 Neu) was one of many conversions, utilizing the Sd.Kfz.251 halftrack chassis and Flak.30/38 Anti-Aircraft Gun.

One of them was "Luftwaffe-Fla ausführung" (air force anti-aircraft version) - Lw35015 kit.

Sd.Kfz.261 became the next variant. It was a hybrid - the front section and chassis is Sd.Kfz.251, behind the drivers seat the armour is newly designed to protect the seated crew and the ammo. It resembles the earlier unarmored platforms at the rear on the soft skinned halftracks.

Prototype Utilized Sd.Kfz.251 Ausf.C, production version - Ausf.D.

Auto-Union A.G. of Chemnitz is awarded contract number 4911-021300306/42 to produce 2400 superstructures at the Horch assembly plant in Zwickau. March 1944 sees the first 5 completed. At the end of February 1945 a total of 604 are produced. Production continued in March April and May, but production statistics didn't survive. The target was 50 a month. It is seen on west and east front.

Already in 1941 the Flak 38 (2 cm) proves not capable to penetrate the Russian armored planes, usually the Ilushin 2. Therefore it was produced almost throughout the war. Most likely, as other vehicles utilizing 2cm. AA guns, it was used most often against ground targets.

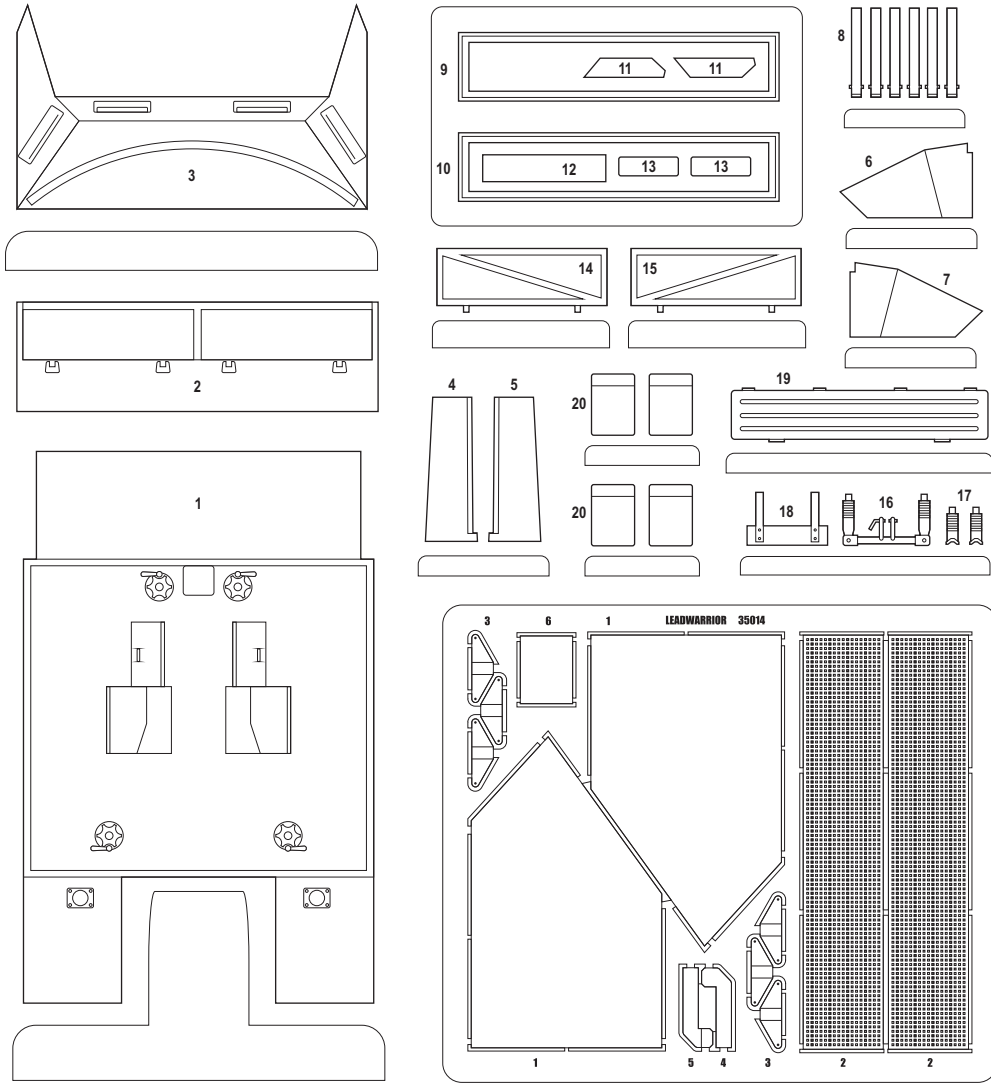

Cut / Remove part

Repeat on mirror side

Optional

Repeat several times

**STUDY THE INSTRUCTION CAREFULLY BEFORE ASSEMBLING.
TEST FIT PARTS TOGETHER BEFORE CEMENTING.
USE CYANOACRYLATE GLUE FOR METAL AND RESIN PARTS.**

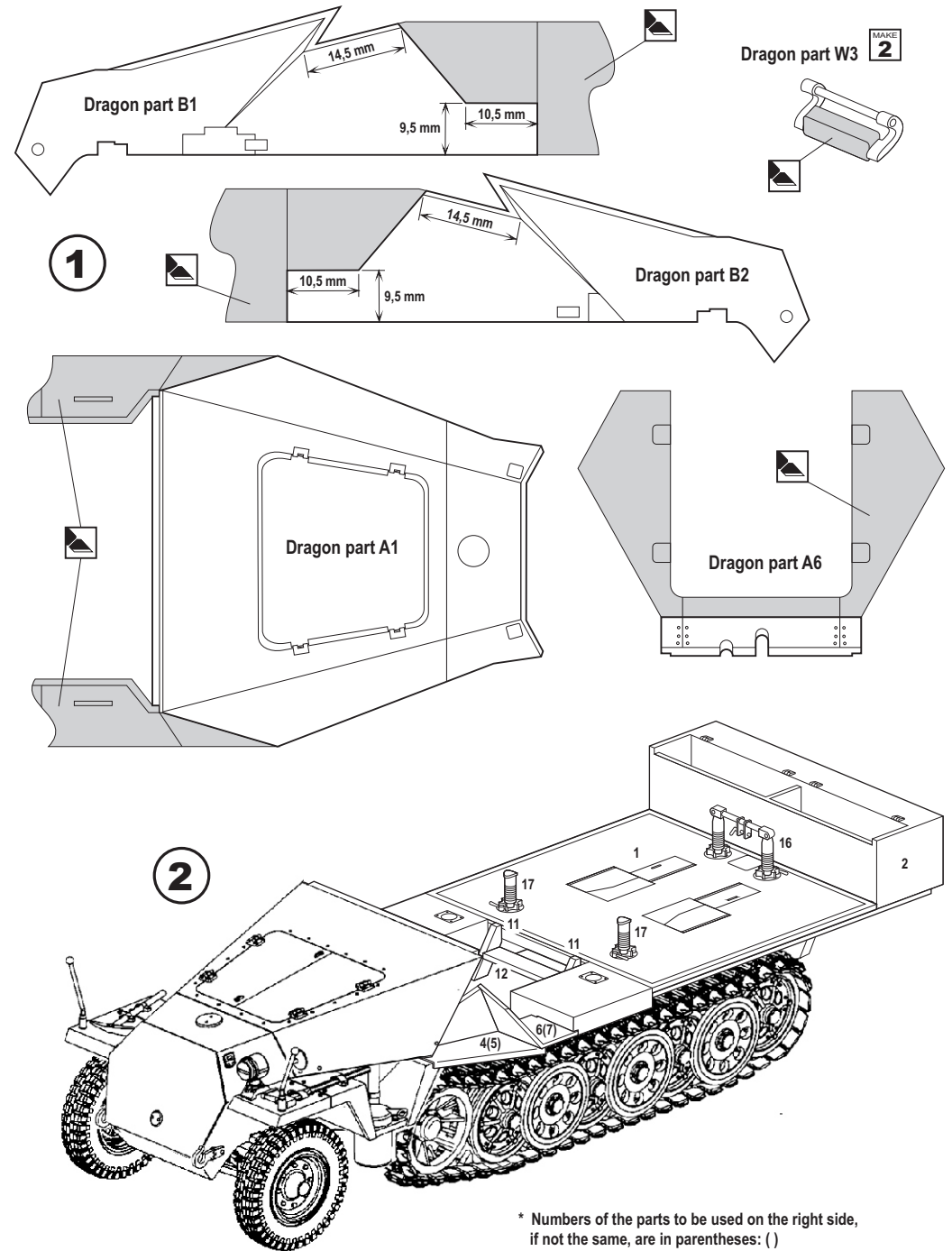

* Numbers of the parts to be used on the right side, if not the same, are in parentheses: ()