



LEADWARRIOR
HISTORICAL MINIATURE

WWW.LEADWARRIOR.COM
INFO@LEADWARRIOR.COM
Ebay: LEADWARRIOR

STEYR Type 1500A L.g.l.Lkw

Light Army Truck (Early Version)

1:35 CONVERSION KIT

For TAMIYA Steyr Type 1500A/01 (Kit # 35225)

18 RESIN PARTS

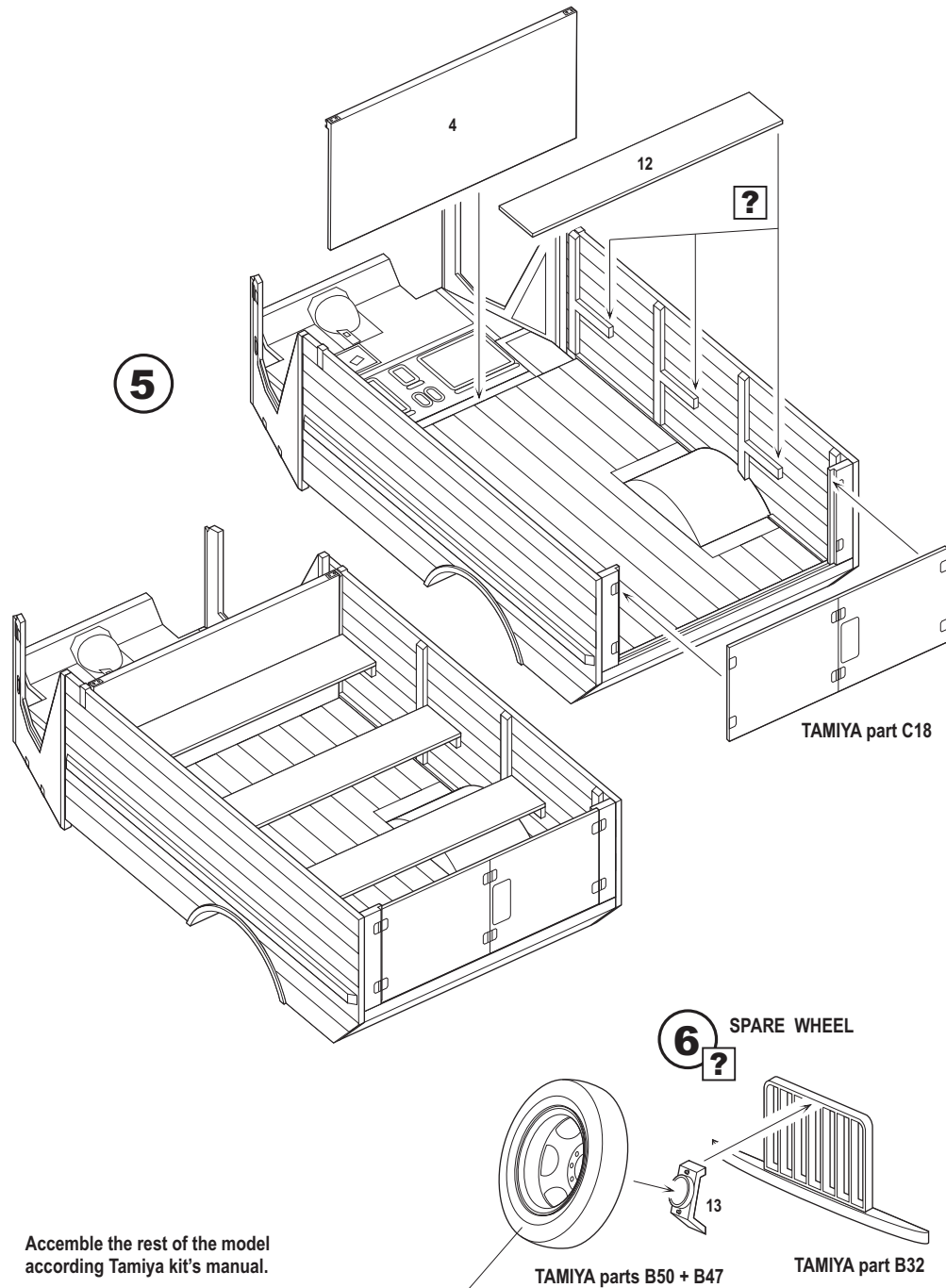
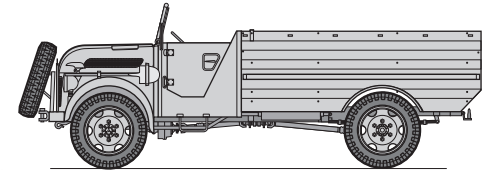

Accemle the rest of the model
according Tamiya kit's manual.

Austria's all wheel drive Steyr 1500A was one of the many personnel/transport vehicles which was designed to meet Whermacht requirement for standard army 1,5 ton truck. Built in 1941, the Steyr was used as troop transport in all the war theaters. A total of more than 20,000 were built, in a wide range of conversions.

Tamiya presents basic and command versions. Also Steyr 1500A chassis were used for Fire trucks, Omnibus (Leadwarrior kit Lw35026), Ambulance or universal "Funk-Koffer" (Leadwarrior kit Lw35025), and different types of cargo and personnel carriers with opened, metal or wooden cabins. There were tests of trucks on railway drive.

The latest vehicle, based on Steyr 1500A chassis, became the redesigned L.g.l.Lkw - (Leadwarrior kit Lw35024) - with full-metal cabin (which was later replaced by wooden - "Einheitsfahrerhaus")

This conversion kit presents early version of L.g.l.Lkw (standard light army truck) on Steyr 1500A chassis. The metal rear section of the basic version was replaced by wooden one, to transport cargo load or 10 men. The rear wheels were doubled. The spare wheel often was mounted in front of engine compartment.

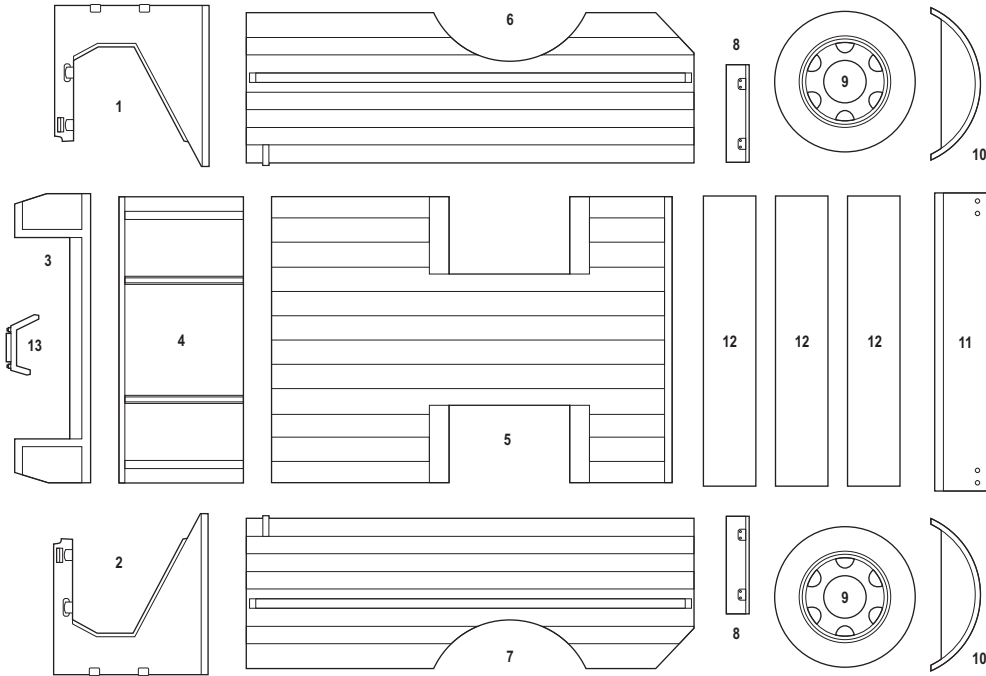

Cut / Remove part

Repeat on mirror side

Optional

Repeat several times

**STUDY THE INSTRUCTION CAREFULLY BEFORE ASSEMBLING.
TEST FIT PARTS TOGETHER BEFORE CEMENTING.
USE CYANOACRYLATE GLUE FOR METAL AND RESIN PARTS.**

